

# RAPTOR R 4x4 ULTIMATE EDITION

## Rear Assembly

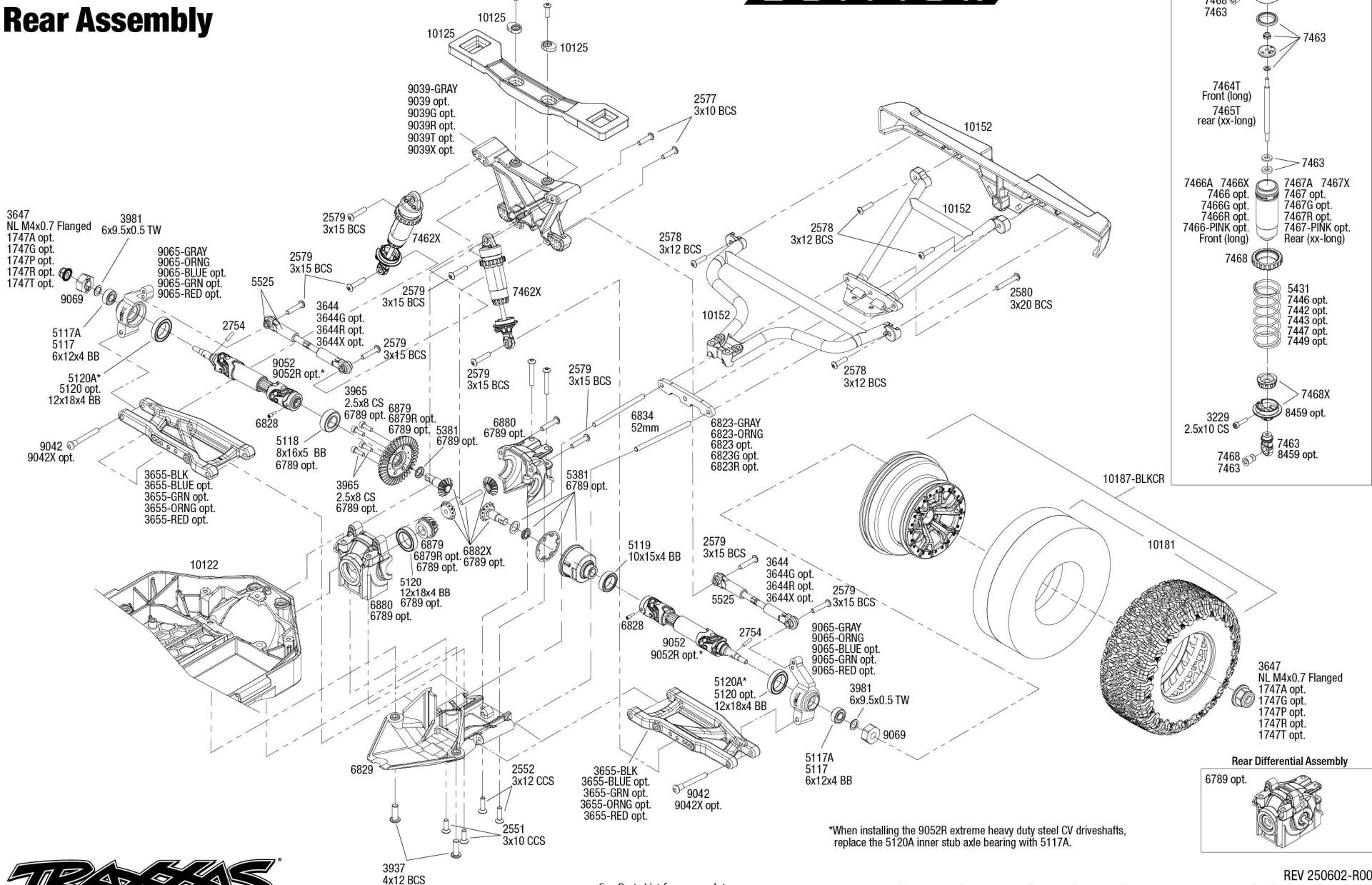

### Shocks Assembly

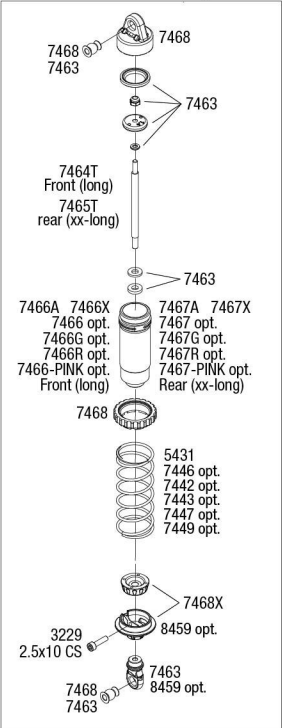

### Rear Differential Assembly

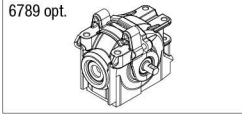

\*When installing the 9052R extreme heavy duty steel CV driveshafts, replace the 5120A inner stub axle bearing with 5117A.



See Parts List for a complete listing of optional accessories.

Specifications on this page are subject to change without notice. Every attempt has been made to ensure the accuracy of this drawing, however Traxxas cannot be held responsible for typographical or other errors.

REV 250602-R00