

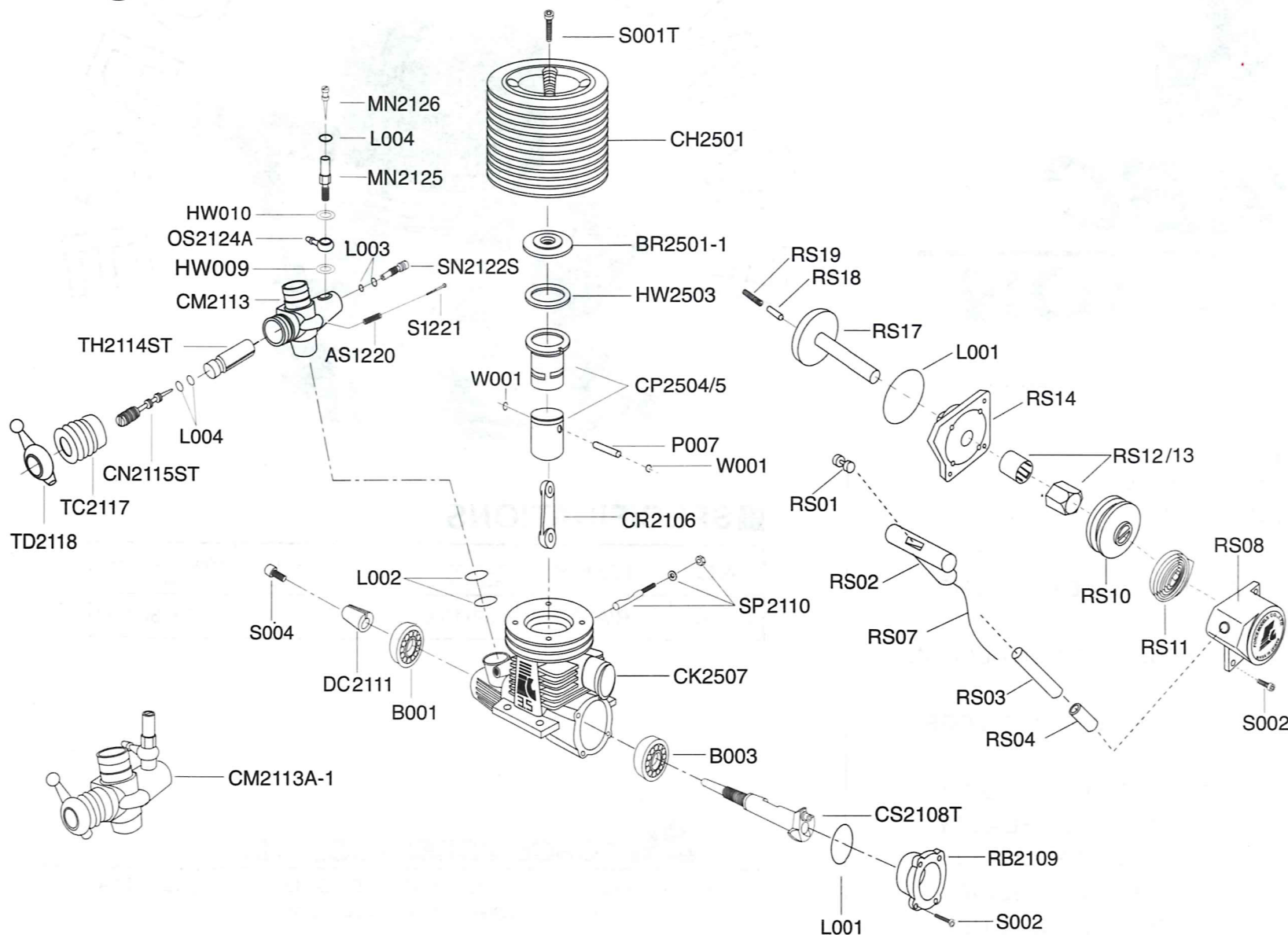

25 R /ABC DIVISION PICTURE

Engine Instructions



PARTS LIST

ITEM NO.	DESCRIPTION
AS1220	ADJUSTED SCREW SPRING
B001	BALL BEARING 607Z
B003	BALL BEARING 6901 13mm
BR2501-1	BURN ROOM
CH2501	CYLINDER HEAD
CK2507	CRANKCASE
CM2113	CARBURETOR MAIN BODY
CM2113A-1	CARBURETOR COMPLETELY SET
CN2115ST	THROTTLE NEEDLE VALVE
CP2504/5	CYLINDER SLEEVE / PISTON
CR2106	CONNECTING ROD
CS2108	CRANKSHAFT 13MM
DC2111	DRIVE BRASS WASHER
HW009	WASHER0.6×4.1×7.5MM
HW010	WASHER0.6×5.1×7.5MM
HW2503	CYLINDER HEAD WASHER-0.2MM
L001	REAR COVER "O" RING
L002	CARBURETOR "O" RING
L003	SUPPLY NEEDLE VALVE "O" RING SET
L004	MAIN NEEDLE VALVE "O" RING
MN2125	MAIN NEEDLE VALVE HUB
MN2126	MAIN NEEDLE VALVE
OS2124A	FUEL NIPPLE
P007	PISTON GUDGEON PIN
RB2109	REAR BACK COVER
S001T	CYLINDER HEAD BOLT
S002	REAR COVER BOLT
S004	CLUTCH WASHER
SP2110	CARB PINCH BOLT
S1221	THROTTLE ADJUSTMENT SCREW
SN2122S	SUPPLY NEEDLE VALVE
TC2117	THROTTLE COVER
TH2114ST	THROTTLE & COUNTER NEEDLE VALVE
TD2118	THROTTLE SCREW CAP
W001	"G" PIN SNAP RING
A PARTS ASSEMBLY DIAGRAM	
A PARTS	
APARTS ASSEMBLY FOR PULL START ENGINE	
RS01	STRING SEAT
RS02	HANDLE
RS03	BUFFER HEAD WASHER
RS04	BUFFER HEAD WASHER SEAT
RS07	STARTING STRING
RS08	REAR COVER
RS10	THREAD SEAT
RS11	EDDY SPRING
S002	REAR COVER WASHER (M2.6*6)
B PARTS ASSEMBLY DIAGRAM	
B PARTS	
B PARTS ASSEMBLY FOR 21 REAR ENGINES	
L001	REAR COVER "O" RING
RS12/13	ONE WAY BEARING SET
RS14	CONNECTIVE SEAT
RS17	STARTING AXLE
RS18	STARTING PIN
RS19	PRESSURE SPRING
S002	REAR COVER SCREW M2.6*6 4PCS