

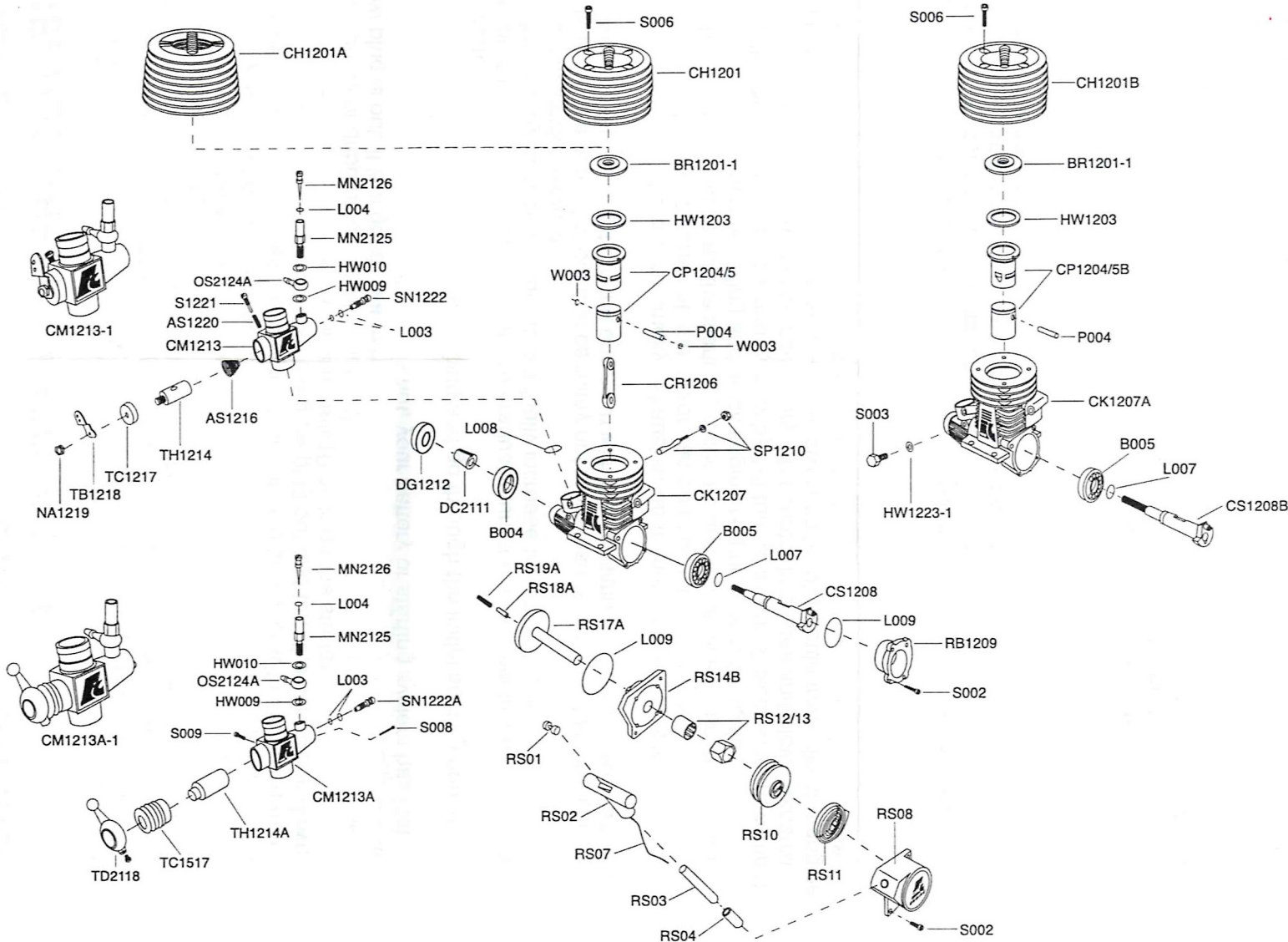

12 SIDE FORCE MODELS

Engine Instructions

ITEM	DISP (C.C.)	BORE (m.m.)	STROKE (m.m.)	OUTPUT PS or BHP/ r.p.m	PARACTICAL RANGE (r.p.m)
12S/ABC	2.11	14.0	13.7	0.56/29,000	3,000~30,000



PARTS LIST

ITEM NO.	DESCRIPTION
AS1216	THROTTLE SPRING
AS1220	ADJUSTED SCREW SPRING
B004	BALL BEARING 689Z (RUBBER)
B005	BALL BEARING 689
BR1201-1	BURE ROOM(12)
CH1201	CYLINDER HEAD (BLUE)
CH1201A	CYLINDER HEAD (CAST HEAD) BLUE COLOUR
CH1201B	CYLINDER HEAD (PRO) SILVER COLOUR
CK 1207	CRANKCASE
CK1207A	CRANKCASE (FOR.12&.15PRO) BLACK COLOUR
CM1213	CARBURETOR MAIN BODY
CM1213-1	CARBURETOR COMPLETELY SET (ROTARY THROTTLE ROD)
CM1213A	CARBURETOR MAIN BODY (SLIDE TYPE)
CM1213A-1	CARBURETOR COMPLETELY SET (SLIDE TYPE)
CP1204/5	CYLINDER SLEEVE/ PISTON 3P (12)
CP1204/5B	CYLINDER SLEEVE/ PISTON 3P (FOR 15PRO)
CR1206	CONNECTING ROD
CS1208	CRANKSHAFT
CS1208B	CRANKSHAFT (FOR.12&.15PRO)
DC2111	DRIVE COPPER CONE
DG1212	DRIVE GEAR
HW1203	CYLINDER HEAD WASHER (12)
HW1223-1	OIL SUPPLY NOZZLE WASHER
L003	SUPPLY NEEDLE VALVE "O" RING
L004	MAIN NEEDLE VALVE "O" RING
L007	CRANKSHAFT "O"RING 1*5MM
L008	CARB URETOR "O" RING
L009	REAR COVER "O" RING
MN2125	MAIN NEEDLE VALVE HUB
MN2126	MAIN NEEDLE VALVE
OS2124A	FUEL NIPPLE
P004	PISTON GUDGEON PIN (12)
RB1209	REAR BACK COVER
S002	REAR COVER BOLT (M2.6*6) 4PCS
S003	SCREW
S005	CYLINDER HEAD BOLT (M2.6*12) 4PCS
S008	THROTTLE STOP ADJUSTMENT SCREW
S009	CARBURETOR SETTING PIN
S1221	THROTTLE STOP ADJUSTMENT SCREW
SN1222	SUPPLY NEEDLE VALVE
SN1222A	SUPPLY NEEDLE VALVE (FOR SLIDE TYPE)
SP1210	CARBURETOR SETTING PIN
TB1218	THROTTLE ROD
TC1217	THROTTLE COVER
TC1517	THROTTLE COVER (FOR SLIDE CARBURETOR)
TD2118	THROTTLE SCREW CAP
TH1214	THROTTLE E & THROTTLE NEEDLE
TH1214A	THROTTLE (FOR SLIDE TYPE)
W003	"G" PIN SNAP RING 2 PCS
A:PARTS ASSEMBLY DIAGRAM	
A PARTS	A PARTS ASSEMBLY FOR PULL STARTER ENGING
RS01	STRING SEAT
RS02	HANDLE
RS03	BUFFER HEAD WASHER
RS04	BUFFER HEAD WASHER SEAT
RS07	STARTING STRING
RS08	REAR COVER
RS10	THREAD SEAT
RS11	EDDY SPRING
S002	REAR COVER WASHER (M2.6X6)
B:PARTS ASSEMBLY DIAGRAM	
B 12	B PARTS ASSEMBLY FOR 12/15S ENGING
RS12/13	ONE WAY BEARING SEAT
RS14B	CONNECTIVE SEAT
RS17A	STARTING AXLE
RS18A	STARTING PIN
RS19A	PRESSURE SPRING
RS18/19A	STARTING PIN & SPRING
S002	REAR COVER SCREW (M2.6X6) 4PCS