



**恒龙模型**  
HengLong Hobby

# 7.4V USB CHARGE

INSTRUCTION MANUAL

请在使用前详细阅读本使用说明书，请保管好本说明书以备不时之用。

说明书内容可能与实物不同，请以实物为准。

Please read the instructions carefully before use. Please keep the instructions ready for occasional use.

The content of the instructions may differ from the physical object, and the latter shall prevail.

## USB 充电线充电方式: Charging mode of USB charger

1. 将USB充电线插入电脑的USB插口(如图)，或插入手机充电器的USB插口(如图)，此时USB充电线电源指示灯亮起。
  2. 再把电池的插头与USB充电线的充电插头按正确极性对接(如图)，此时USB充电线电源指示灯变为全亮闪烁，进入充电状态，约4小时后电源指示灯变为熄灭，此时充电完成。
1. Insert the USB cable into the USB port on the computer (as shown in the figure), or the mobile phone charger (as shown in the figure). Now, the indicator light of the USB cable will light up;
  2. Then connect the plug of the battery with that of the USB cable in line with their polarity (as shown in the figure). The indicator light of the USB cable will be fully on and flash, which denotes that it has started to getting charged. About 4 hours later, the indicator light of the power will turn off, indicating that electricity is full.

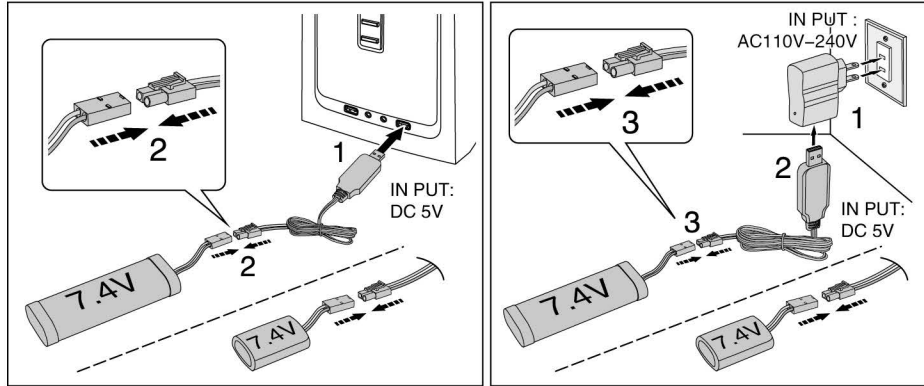

## 警告 Warning

本USB充电线为本产品中的7.4V带保护板锂电池专用的，严禁为其它任何电池充电，否则造成危险，后果自负！

This USB charging wire is special for 7.4V lithium batteries with protective plate. It is forbidden to charge any other batteries, otherwise it will cause danger and the company won't bear the consequences.

## 电池使用注意事项 Caution:

1. 电池充电时，务必使用本套材内专用的USB充电线，以免造成危险！
2. 请小心维护电池，按标准充电时间为电池充电，以延长使用寿命，避免不当使用而造成电池损坏。
3. 勿将正负极接反！勿将电池组投入水中或将其弄湿！

4. 禁止在火源或极热条件下给电池组充电！勿在热源(如火或加热器)附近使用或贮存电池组！如果电池泄漏或发出异味，应立即将其从接近明火处移开。第一次使用电池，需将电池充满电后再使用。
  5. 勿将电池组投入火中或给电池组加热！
  6. 禁止用导线或其他金属物体将电池组正负极短路！
  7. 禁止用钉子或其他尖锐物体刺穿电池组壳体，禁止锤击或脚踏电池组！
  8. 禁止以任何方式分解电池组和电池！
  9. 禁止将电池组置于微波炉或压力容器中！
1. When the battery is getting charged, please use the special USB cable of this material to avoid danger!
  2. Please take good care of the battery pack. Before charging. Please charge the battery pack according to standard charging time to prolong its service life, avoid damage of battery caused by improper use.
  3. Do not reversely connect the positive and negative poles! Do not put the battery pack into the water or wet them!
  4. Do not charge the battery pack under fire or extremely hot environment! Do not use or store battery pack near heat sources, such as fire or heaters! If the battery leaks or smells, please remove it immediately from the place that is close to the open fire. Before the first use, the battery should be fully charged.
  5. Do not put the battery pack into the fire or heat them!
  6. Do not use wires or other metal objects to short-circuit the positive and negative poles of the battery pack!
  7. Do not use nails or other sharp objects to pierce the battery pack shell; do not hammer or pedal the battery pack!
  8. Do not disassemble the battery pack or the battery in any way!
  9. Do not put battery pack in microwave ovens or pressure vessels!

## 敬告 (Notice)

尊敬的用户：

本产品是配置一种环保节能的锂电池作为供电电源，请您在使用中严格遵守使用规则，这样你的锂电池才能正常使用。

1. 首次使用锂电池组时须先充满电再使用；
2. 每次使用后（不论使用时间长短）都应取出电池重新充电，保持电池处于带电状态；
3. 当使用电池达到电量极限时，须尽快充电，如在电池过放电情况下，搁置不充，会严重损伤电池的寿命及性能或导致电池永久性损坏；
4. 电池组不能使用处于极热环境中，如阳光直射或热天的车内，否则，电池组过热，这样就会影响性能、缩短电池组的使用寿命。
5. 环境温度会影响放电容量，环境温度超标准环境时（ $25^{\circ}\text{C} \pm 5^{\circ}\text{C}$ ），放电容量会有所降低。
6. 电池组在充放电过程中，如果出现异味、异常声响，请立即停止充电或放电。

Dear users:

This product is equipped with an eco-friendly and energy-saving lithium battery as the power supply. Please strictly abide by the instructions while using it, so that your lithium battery can work normally.

1. Before the first use, the lithium batteries must be fully charged.
2. The battery should be recharged after each use (no matter how long it was used) to keep the battery charged;
3. When the battery is about to run out, it should be recharged as soon as possible. If the battery is not recharged in case of over-discharge, the battery cycle life and performance will be seriously damaged or the battery will be permanently damaged;
4. Batteries cannot be used in extremely hot environments, such as under direct sun light or in a car in hot weather. Otherwise, the overheated batteries will affect the performance and shorten the cycle life.
5. Ambient temperature will affect the capacity of electric discharge. When ambient temperature exceeds the standard environment ( $25^{\circ}\text{C} \pm 5^{\circ}\text{C}$ ), the capacity of electric discharge will decrease.
6. During the charging and discharging of the batteries, if an abnormal odor or sound appears, please stop the charging or discharging immediately.