

Thanks for purchasing this product which is one of the most popular products in the RC market. It is easy to install and operate, and is the first choice by most RC cars amateurs. Please carefully read this manual in order to reach the ideal effect you want. We believe your car will be a very beautiful scene on racing track with the accompany of our product!

## Content:

- |                            |                        |
|----------------------------|------------------------|
| 1. Car LED ×12 pcs.        | 4. Power connection.   |
| 2. Car LED holder ×12 pcs. | 5. Control connection. |
| 3. Control box ×1 pc.      | 6. Accessories parcel. |

## Specification:

- |                               |                                      |                 |
|-------------------------------|--------------------------------------|-----------------|
| 1. Input voltage: 4.8V- 6.0V. | 4. LED wire: 35cm.                   | 7. Weight: 50g. |
| 2. Working current: 100mA.    | 5. Control wire: 28cm.               |                 |
| 3. Dimension: 47×30×12mm.     | 6. Power core connection wire: 20cm. |                 |

## Set up:

1. Choose a car body and install the LED holder in the car body.
2. Put the LED into the LED holder.
3. Connect each LED with the plug in the corresponding control box based on the instruction.
4. Stick the main control box on the top of car body properly.
5. Mount the car LED wire and avoid the interference of the wheels' turn or spin.
6. Fix all the wires and check whether they are set correctly.

\* LED could be installed flexiably, according to your preference.

## Modes:

After plug in, enter the car mode. Press control button "SET" to enter the following 4 modes.

1. All car LED is on.
2. For the front car LED, the White light is flashing quickly, the blue light is always on. For the back LED, the White LED is always on, the Yellow and Red lights are flashing quickly.
3. For the front car LED, the White and blue lights are flashing in the highest speed frequency in a loop. For the back car LED, the White, Yellow, Red lights are flashing in the highest speed frequency as well.
4. For the front car LED, the White LED is always on, the Yellow LED is flashing slowly. For the back car LED, the white and yellow lights are flashing at the same time, and they are flashing with Red LED alternatively.

## Diagram:

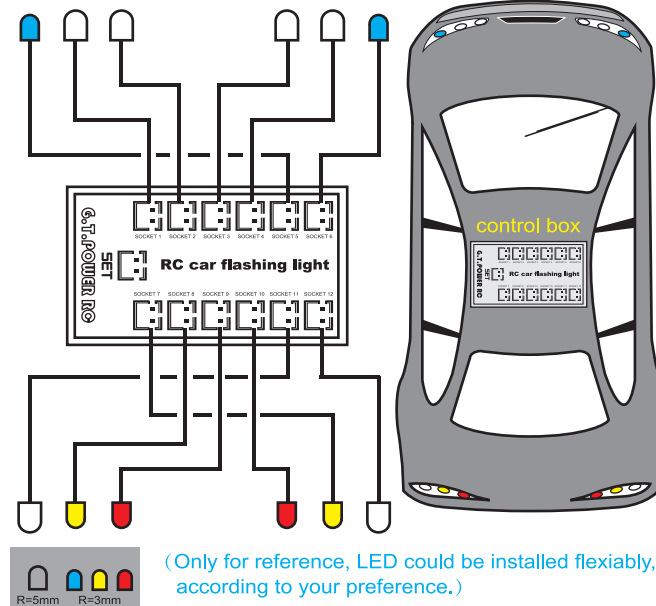

## Note:

1. Please carefully read our manual before setting up the product.
2. Please don't use the power supply that is over the safe voltage.
3. Please avoid water while using in case of short-circuit.
4. Please keep this manual for viewing at any time.

感謝您購買本產品, 它是目前R/C市場上最受青睞的產品之一。它易於安裝, 操控簡捷, 深受廣大車模愛好者的喜愛。為達到你想要的理想效果, 請仔細參閱本說明書。相信在他的相伴下, 你的愛車一定會是跑道上的一道亮麗的風景。

#### 產品清單:

1. 車燈×12pcs.
2. 車燈座×12pcs.
3. 一個控制箱。
4. 電源連接線。
5. 控制連接線。
6. 附件包。

#### 產品規格:

1. 輸入電壓: 4.8V-6.0V。
2. 工作電流: 100mA。
3. 尺寸: 47×30×12mm。
4. 車燈線長度: 35cm。
5. 控制連接線: 28cm。
6. 電源連接線: 20cm。
7. 重量: 50g。

#### 產品安裝:

1. 選擇一個車殼, 裝上車燈座。
2. 將車燈置入燈座內。
3. 將各車燈按控制要求與控制箱內相應插座相連。
4. 把主控制箱粘在車殼頂部合適的位置。
5. 固定好車燈線, 避開車輪運轉及轉向的干擾。
6. 安裝好所有的電線, 並檢查都已正確安裝。

\*燈的位置可依個人喜好, 靈活安裝。

#### 產品模式:

接通電源後, 即進入車燈模式。按控制鍵“SET”可進入以下四種模式。

1. 車燈全亮。
2. 前車燈白燈快閃, 藍燈常亮; 後車燈白燈常亮, 黃、紅燈快閃。
3. 前車燈白、藍燈迴圈爆閃; 後車燈白、黃、紅燈迴圈爆閃。
4. 前車燈白燈常亮, 藍燈慢閃; 後車燈白、黃燈同閃並與紅燈交替閃爍。

#### 安裝示意圖:

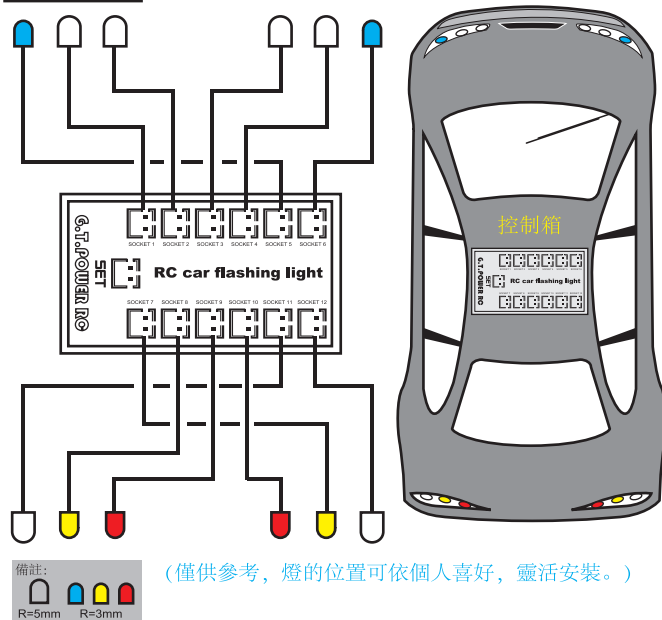

#### 注意事項:

1. 請仔細閱讀完本說明書後再安裝產品。
2. 請不要使用超過安全電壓的電源。
3. 請不要在雨中使用本產品, 以免短路。
4. 請妥善保管本說明書, 以便隨時查閱。