

EASYCOAT®

A NEW GENERATION OF THERMAL-SHRINK FILM COVERING

EASYCOAT® is a **NEW** development in polyester covering film for model aircraft which can be ironed on or heat gunned. What makes **EASYCOAT®** stand out are its excellent shrinking qualities and extremely easy application. **EASYCOAT®** consists of a **SPECIAL POLYESTER BASED MATERIAL** and a **SPECIAL** pigmented **THERMO-ACTIVATED IRON-ON ADHESIVE**. **EASYCOAT®** has excellent symmetrical shrinking qualities, which can be directly and easily regulated by applying heat with the help of a hobby covering iron or a heat gun. **EASYCOAT®** can be applied within a wide range of temperatures. For 'standard' ironing on you need approx. 100 - 120°C. At this temperature **EASYCOAT®** keeps relatively stable dimensions. If you raise the temperature the material will begin to shrink in equal proportion to the rise of temperature. At 150°C there will be approx. 10 % shrinkage biaxially i. e. lengthwise and crosswise. The melting point is 250°C. **EASYCOAT®** is environmentally friendly as it contains no heavy metals.

INSTRUCTIONS FOR USING EASYCOAT®

1. TOOLS YOU WILL NEED:

- | | | |
|--|-----------------------------------|---|
| <input type="checkbox"/> Hobby covering iron | <input type="checkbox"/> Heat gun | <input type="checkbox"/> Single edge razor or modelling knife |
| <input type="checkbox"/> Scissors | <input type="checkbox"/> Ruler | <input type="checkbox"/> Soft cloth |

2. SURFACE PREPARATION:

Take time and sand your model completely. Fill gaps and dents with CARL GOLDBERG model magic or similar. Finish sanding with 320 grade sandpaper, always using a sanding block. Completely vacuum and then wipe the structure free of all dust. **DO NOT** use any painted-on preparation before covering. **EASYCOAT®** should be applied directly to clean bare wood.

3. SETTING TEMPERATURE OF YOUR COVERING IRON:

If you do not have a covering iron with a reliable thermostat you can measure the temperature with a covering thermometer or use the following simple checks to adjust your iron:

- A **Low** range: 100°-120°C - **EASYCOAT®** can be ironed on to balsa wood without developing much shrinkage.
- B **High** range: approx. 150° C - Now **EASYCOAT®** shrinks by approx. 10 % biaxially.

NOTE: In order to prevent wrinkles on difficult curves it is better to use a heat gun instead of a covering iron. Curves are simply 'shrunk around'. For more shrinkage you can raise the temperature to more than 200°C as the film does not melt below 250°C.

4. SEAMS:

All seams should overlap by at least 1 cm.

5. APPLICATION OVER OPEN FRAMEWORK (WINGS): BOTTOM

To balance the air pressure we recommend drilling 2 holes of 3 mm diameter through each rib. This will prevent a bellying out of the covering when applying the heat gun. For covering of the wing cut a piece of **EASYCOAT®** around the bottom of the wing approx. 2 cm oversize in the areas of the leading edge and trailing edge and approx. 5 cm oversize in the areas of the wing tip and the root rib. Discard the protective backing (If it does not separate easily, stick a piece of tape both to the backing and to the **EASYCOAT®** side, grip each end of tape and pull apart.) Lay the cut out piece of **EASYCOAT®** as flat as possible on the bottom of the wing, with the adhesive side down. Set the iron to 100°-120°C. Iron **EASYCOAT®** on to the wing, all along the edges (leading and trailing edge, root rib), but letting it trail at the wing tip. In any case avoid ironing wrinkles into the film, as this would destroy the colour pigment layer. Areas you cannot iron on smoothly will simply be smoothed down by a heat gun after the film has been fastened down. For ironing the film on to the wing tip pull the **EASYCOAT®** around the wing tip and iron it on to the top of the wing, to avoid ironing in wrinkles. Now you can simply shrink the film down to the wing tip by using the heat gun. When the covering is completely fastened all around the edges shrink it on with a heatgun. For better adhesion gently rub the covering down with a soft cloth, as long as it is still hot the adhesive is active. Finally trim the film edges all around and seal them with the iron set to high temperature.

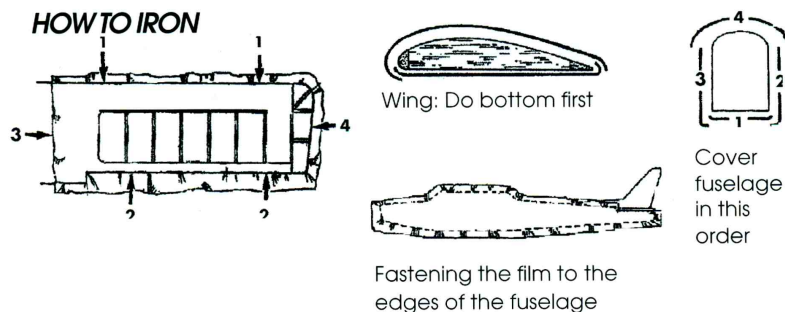

6. APPLICATION OVER OPEN FRAMEWORK (WING): TOP

Covering the top of the wing will be the same procedure as the bottom.

7. COVERING THE FUSELAGE:

Cut the **EASYCOAT**[®] to the outline of the surface to be covered with about 1 cm overlap. Discard the protective backing. Position the **EASYCOAT**[®] on the side of the fuselage to be covered, adhesive side down. Fasten the film only to the outer edges of the side of the fuselage, at approx. 100°-120°C. Then trim the film edges and iron them on. Use the heat gun to shrink the film on to the side of the fuselage. As long as the adhesive is still hot, rub film down with a soft cloth, to achieve a tight bond to the surface.

Covering the other side of the fuselage will be the same procedure.

8. HELPFUL HINTS:

FIRE WALL

- Bond all edges around engine area with a hot iron to prevent fuel seepage under the covering. Coat the inside of the engine with epoxy resin or fuelproofer overlapping the fuel proofer on to the covering.

STYRO FOAM

- **EASYCOAT**[®] can be applied to styro foam at low range (100°C). Use a test piece of foam to get the feel of the material.

PAINTING

- **EASYCOAT**[®] can easily be painted. Polyurethanes, model epoxy paints and automotive acrylic enamels can be used. DO NOT use model dopes.

CLEAN-UP

- Any paint or adhesive left on your iron or smeared on your covering can be removed with a clean rag while the iron is still hot. **NEVER** use solvents to clean a hot iron!

DECALS

- Follow manufacturer's instructions.

PATCHINGS AND REPAIRS

- To be sure a patch bonds well take care to remove all traces of fuel and exhaust residue. For simple tears cut patch 1-2 cm larger than the area to be repaired. With the iron set to 100°C apply the patch directly to the leaned surface. Or, for a neater repair, carefully cut out the entire bay and apply a new patch with a minimum of 1 cm overlap.

We would appreciate further suggestions or comments regarding **EASYCOAT**[®] and its application.

LANITZ-PRENA FOLIEN FACTORY GmbH,

Am Ritterschloßchen 20, D-04179 LEIPZIG

Tel.: 0341-451 25 12 • Fax: 0341-451 25 34